

FOR SALE

RESIDENTIAL - EXECUTIVE CONDO 786SQFT (73SQM) / CALL FOR PRICE!

+65 8688 6565



2 - Bedroom Deluxe

TYPE B1-P

73 sqm | 786 sqft

TYPE B1

73 sqm | 786 sqft

TYPE B1-PH

92 sqm | 990 sqft

(Exclusive of 19 sqm shared voids over living/dining)

Tower 33 #14-11

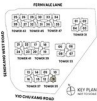
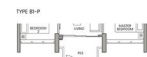

RESIDENTIAL - EXECUTIVE CONDO

31, 33, 35, 37, 39, 41, 43, 45, 47 FERNVALE LANE,
SELETAR, YIO CHU KANG, SINGAPORE 797504

- LISTING ID: SGLD49560877
- TENURE: LEASEHOLD 99
- TITLE: N/A
- SIZE BUILT-UP: 786SQFT (73SQM)
- SIZE LAND: 4.233AC (1.713HA)
- NO. OF FLOORS: 14
- FLOOR/LEVEL: N/A - N/A
- BED ROOMS: 2
- BATH ROOMS: 2
- MAIDS ROOMS: N/A
- PARKING SPACES: N/A
- LAYOUT TYPE: OTHER
- FACING: N/A
- VIEWING: OTHER
- SELLING PRICE: **CALL FOR PRICE!**
- COMPLETION YEAR: 2026
- CONDITION: ORIGINAL CONDITION
- FURNISHING: PARTIALLY FURNISHED
- LISTING DATE: JUL 09, 2021

PARC GREENWICH

Executive Condo for Sale: Partially furnished, 2 bedroom, 2 bathroom. Completed in 2026, this unit is in original condition. Tenure: Leasehold 99 Located in Singapore's district D28 near Seletar, Yio Chu K in the area North East (North East region).

INTERIOR FACILITIES

- Air-Conditioning
- Bombshelter
- Balcony

OTHER INTERIOR FEATURES

- Cooker Hob/Hood
- Oven / Microwave
- Intercom
- Water Heater

EXTERIOR FACILITIES

- 24 Hours Security
- Clubhouse
- Billiards Room
- Covered Car Park

VISIT THIS PROPERTY AT: <https://www.singaporenewlaunches.com.sg/property/SGLD49560877>

CYNTHIA CHAN - HUTTONS ASIA PTE LTD

3 Bishan Place #05-01 CPF Bishan Building
D20, 579838, Singapore

+65 8688 6565
WhatsApp Me

cynthiachan.huttons@gmail.com

<https://www.singaporenewlaunches.com.sg>



Scan QR Code

L3008899K
R043209E

Huttons® Call for Viewing
The Agency of Choice +65-86886565